

ITEM NO.	FILE NAME	DESCRIPTION	QTY.
1	Yaw_Motor_Base_v02	Gimbal Base	1
2	Thin_Motor	RCTimer GBM2804 -019-100T	2
3	Pan_and_Tilt_Yaw_Arm_v01	Yaw Arm	1
4	Cam_Mount_Side_Plate_v02	Tilt Mount Plate	1
5	Mob_Cam_Mount_Plate_v02	Camera Plate	1
6	Mobius	Mobius Action Cam-C Lens	1
7	Mobius_GelPad_Narrow	Align PU Gel - 20mm x 45mm x 3mm	1

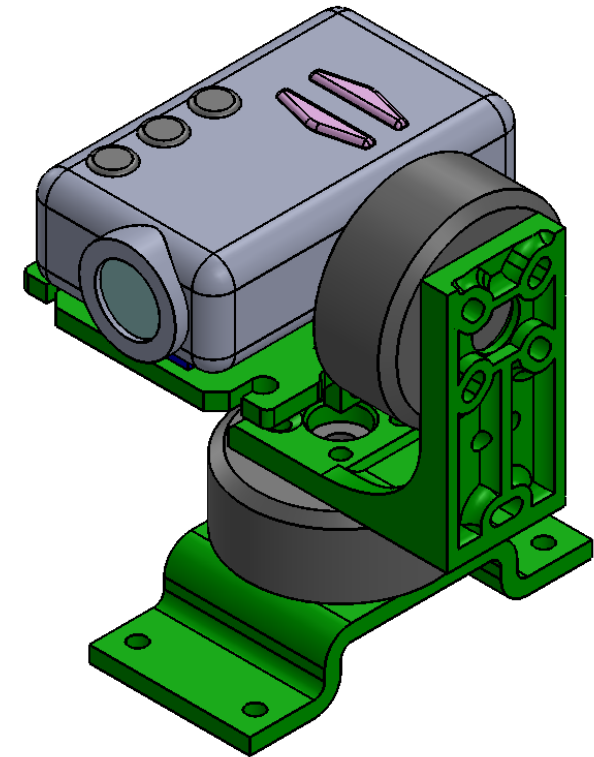
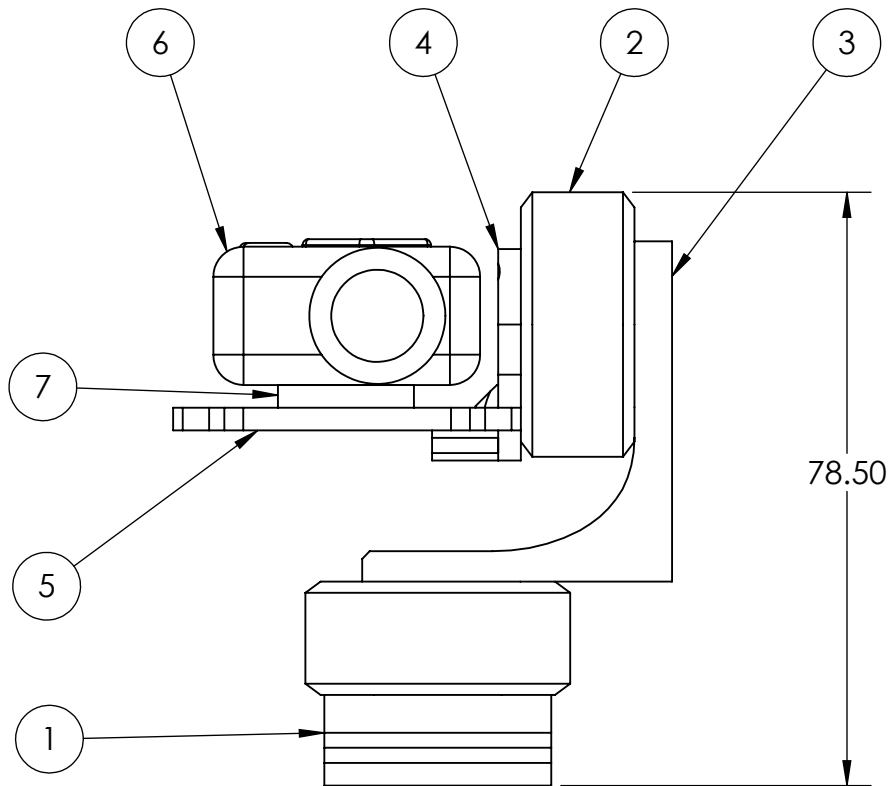

Mobius Pan and Tilt Brushless Gimbal

Another Gimbal project by mark_q
© 2016