

Heavy Duty Pan & Tilt

Standard Unit

BY MARK Q
OCT, 2016

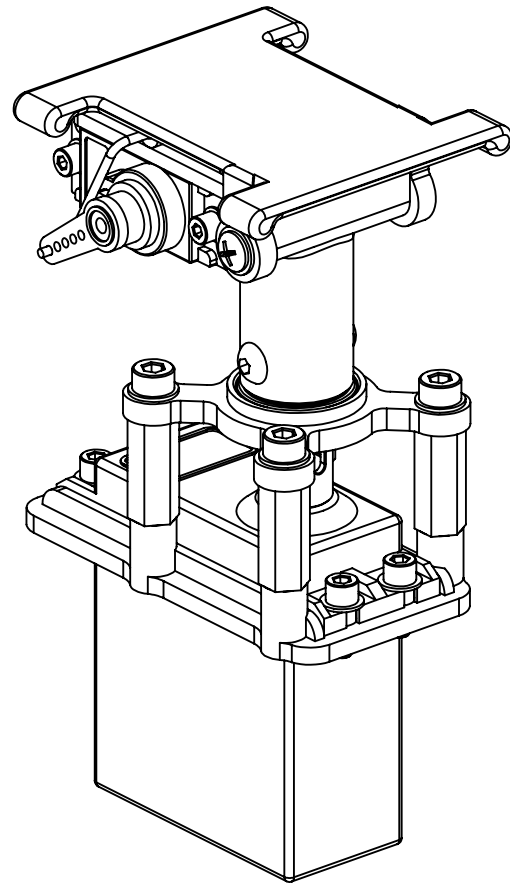

Base Unit

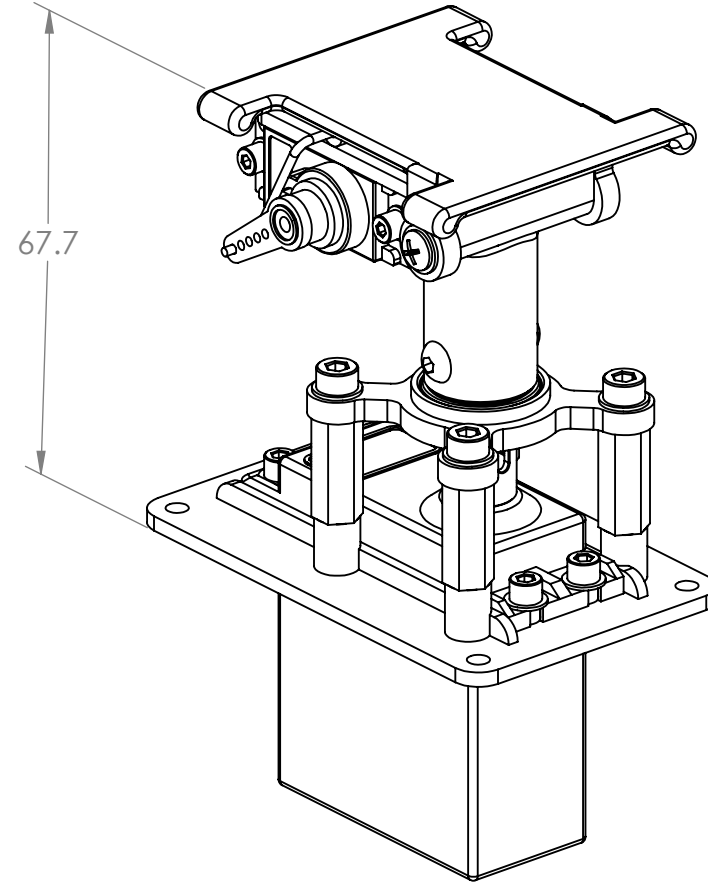

Servo Deck Plate

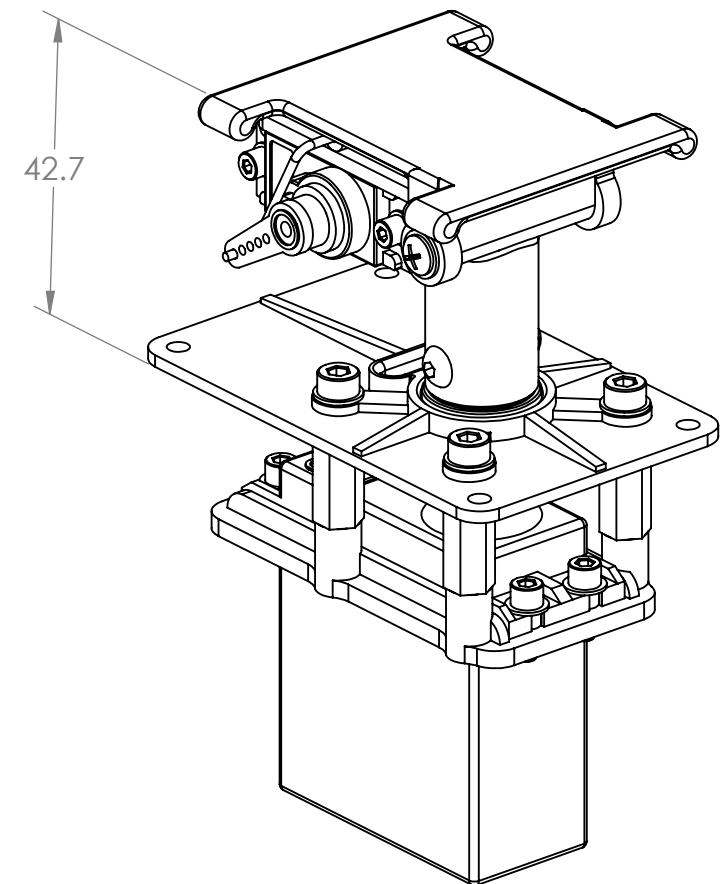

Bearing Deck Plate

Heavy Duty Pan & Tilt Mount Configurations

BY MARK Q
OCT, 2016

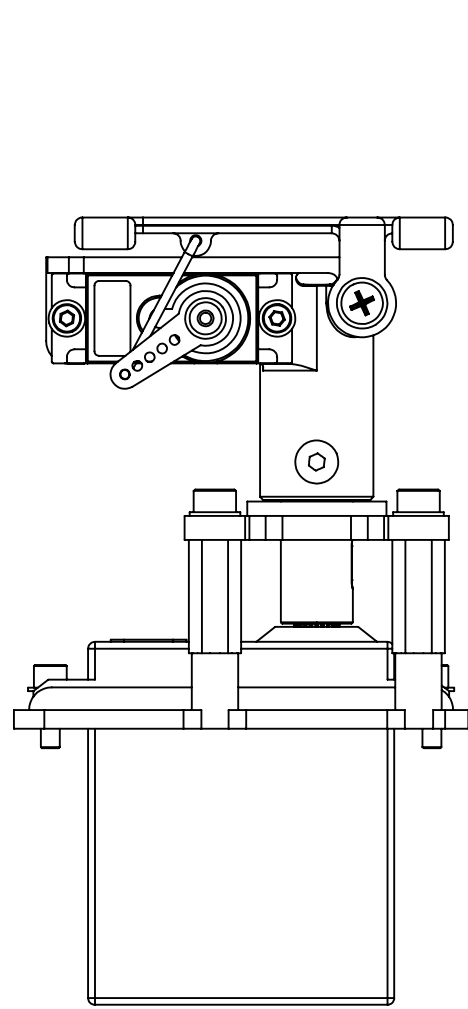

0 Degrees

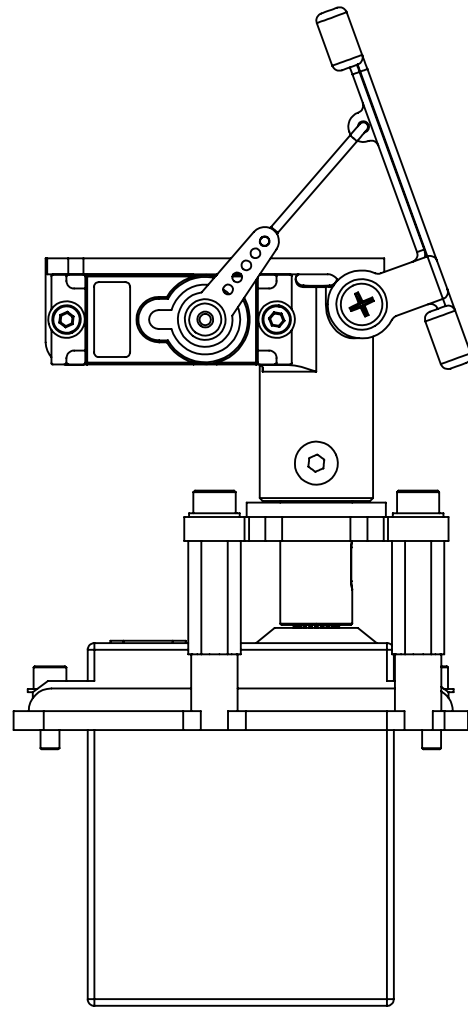

70 Degrees

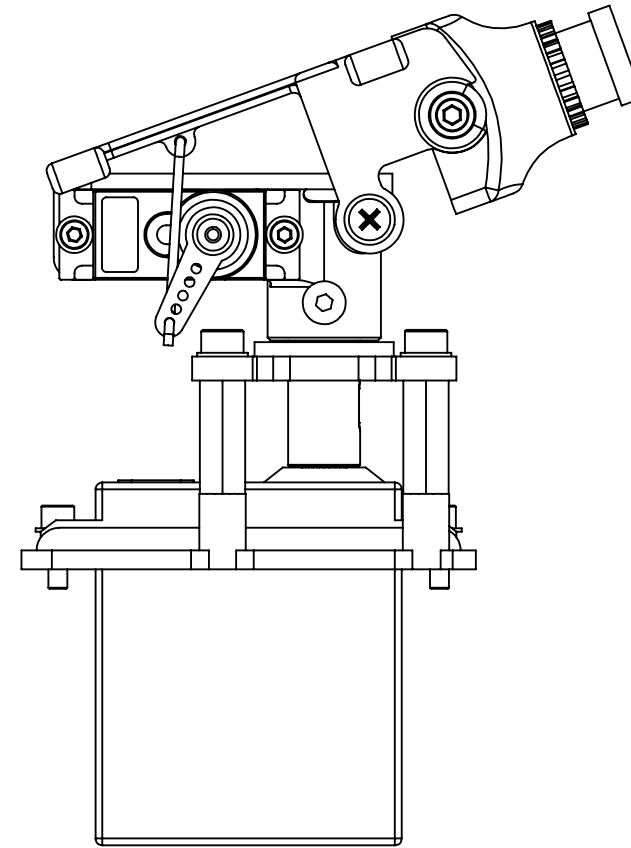

-20 Degrees

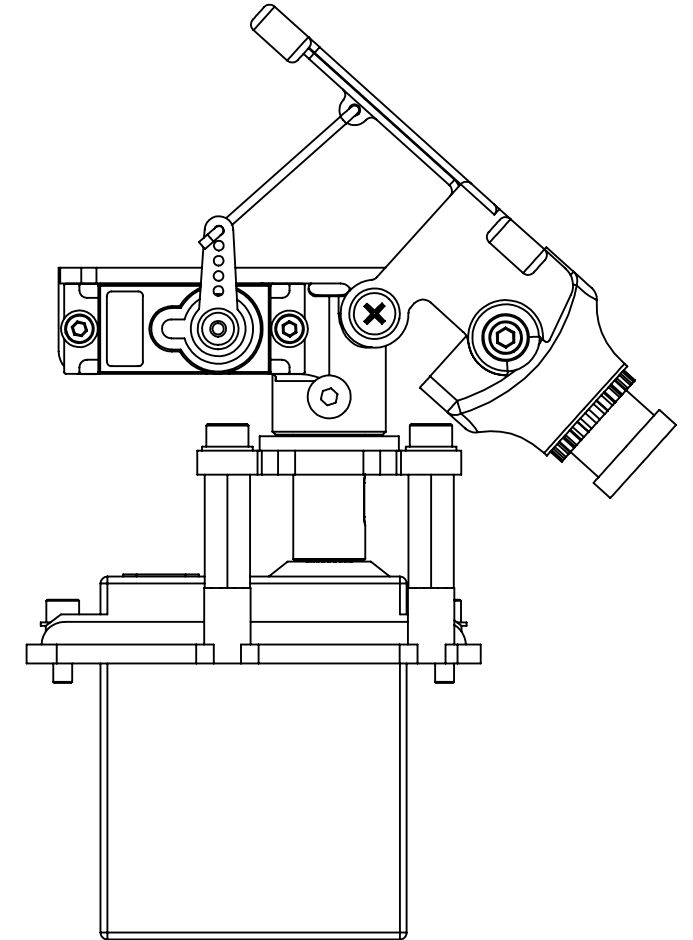

42 Degrees

Standard Range of Motion

Over-Under Range of Motion

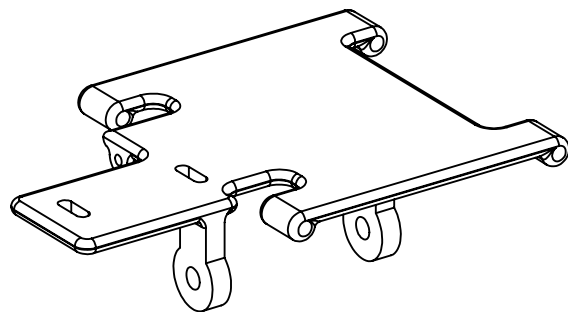

Dual Camera Mount

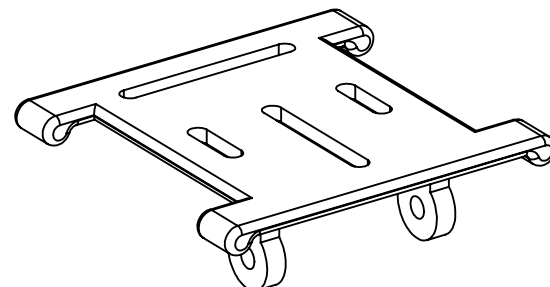

Misc Camera Mount

Alternate Standard Camera Mounts

Heavy Duty Pan & Tilt Range of Motion

BY MARK Q
OCT, 2016